

Prepared for the exclusive use of
Mark McDougall - Realtor

2070 Sooke Road
Victoria, BC

Date:

April 27, 2010

Design and Production



250-744-1537

floorplan@homelands.ca

Measurements and Square Footage are
approximate. Buyer to verify on-site

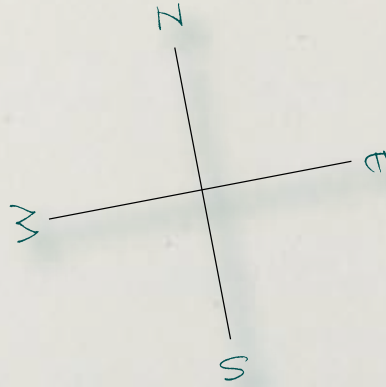

Square Footage

Upper Finished: 1493

Lower Finished: 1214

Lower Garage: 264

Lower Total: 1478

Total Finished: 2707

Garage: 264

Overall Total: 2971

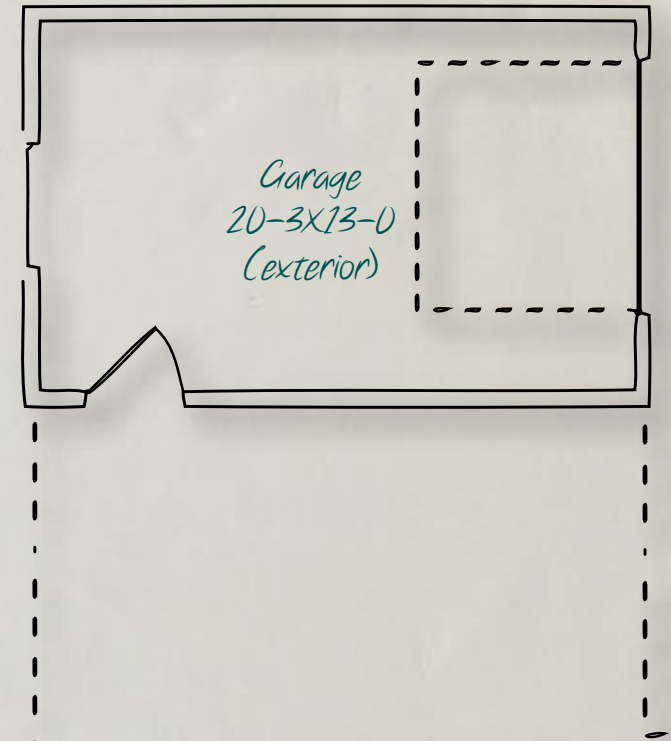

Garage
20-3X13-0
(exterior)

